

LAND FOR DEVELOPMENT—PINSON



- 29.01± Acres \$870,300 (\$30,000 per acre)
- Zoned C-1 (Neighborhood Commercial) & I-4 (Industrial Park)
- All utilities available including sewer
- Jefferson County
- Located on the corner of Red Hollow Road & North Carson Road
- Next door to Tree Top Apartments



R041911PP

Information deemed reliable but not guaranteed.

Steve House 
(205) 408-9911
steve@ponderproperties.com

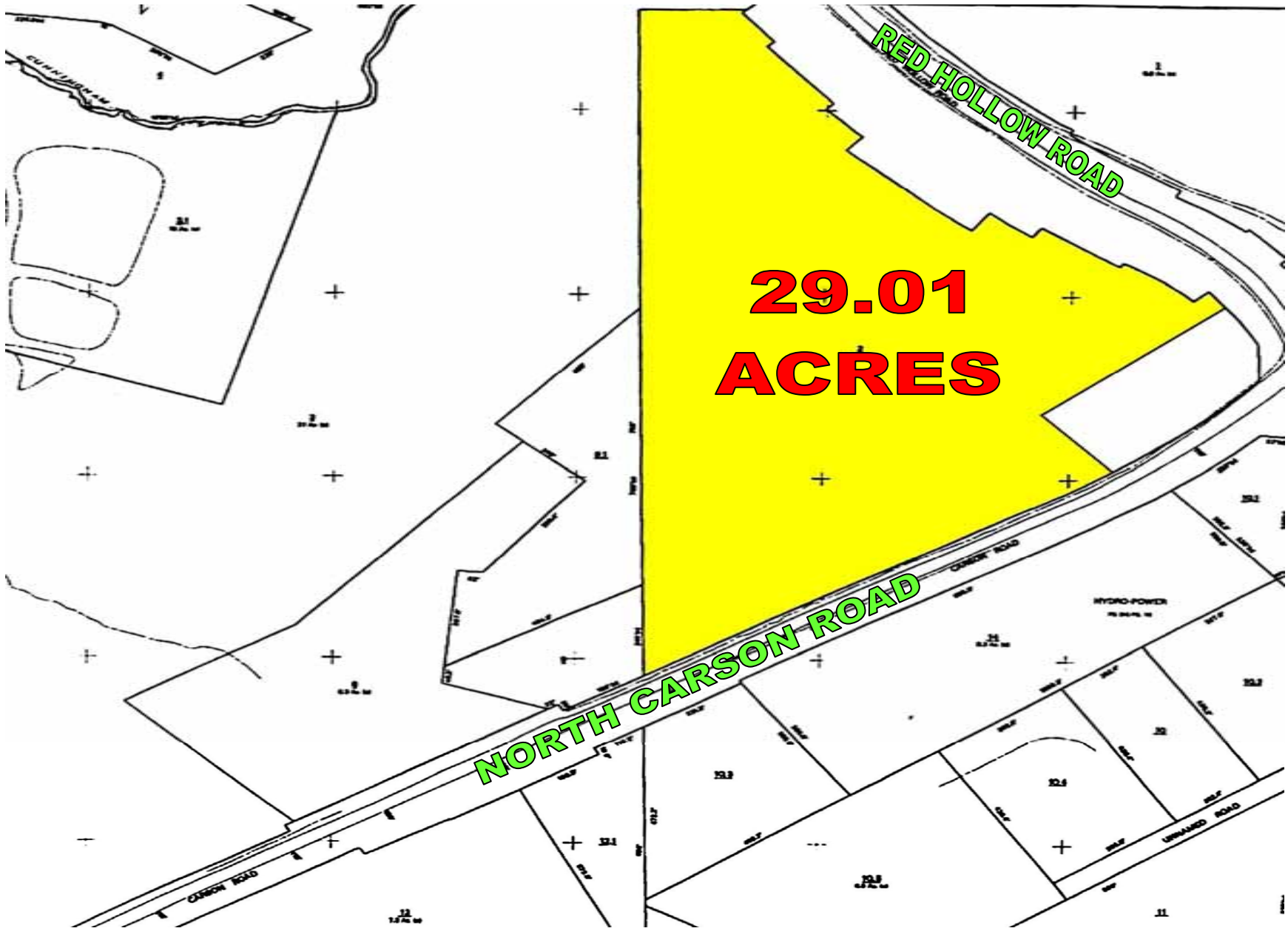

**29.01
ACRES**

RED HOLLOW ROAD

NORTH CARSON ROAD

CUNNINGHAM HOLLOW

HYDRO-POWER

UNIMPROVED ROAD

21
22.00' L'

22
22.00' L'

23
22.00' L'

24
22.00' L'

25
12.00' L'

26
22.00' L'

27
22.00' L'

28
22.00' L'

29
22.00' L'

30
22.00' L'

31
22.00' L'

32
22.00' L'

33
22.00' L'

34
22.00' L'

35
11

36
22.00' L'

37
22.00' L'

38
22.00' L'

39
22.00' L'

40
22.00' L'